

IT

EN

CTH 330

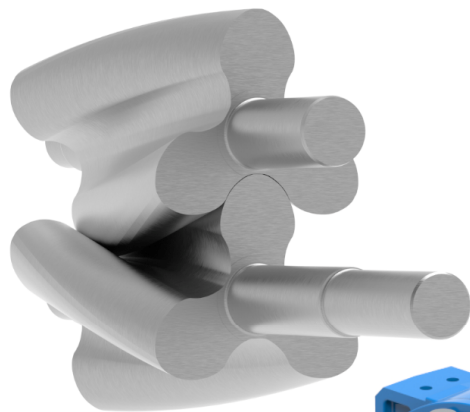
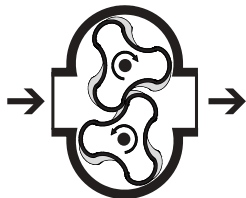

**NEW**

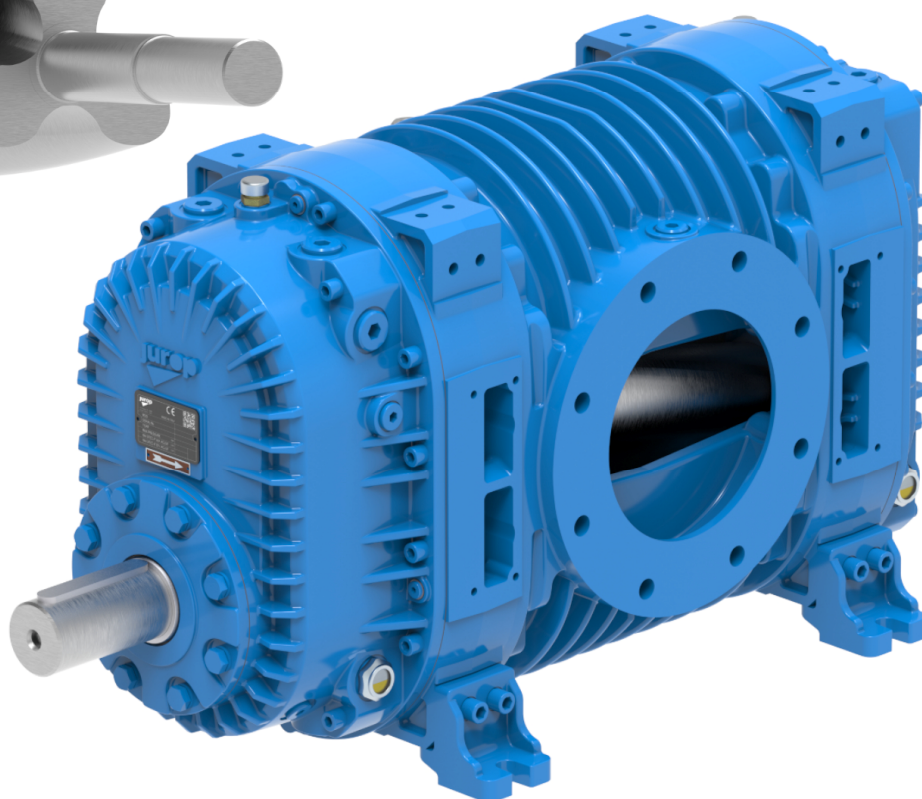

**POMPE / PUMPS**

**Compressore a lobi elicoidali**  
PER BASSE PRESSIONI

**Helical tri-lobe compressor**  
FOR LOW PRESSURE RATES



COMPANY WITH  
QUALITY SYSTEM  
CERTIFIED BY DNV  
ISO 9001

COMPANY WITH  
ENVIRONMENTAL SYSTEM  
CERTIFIED BY DNV  
ISO 14001

**CARATTERISTICHE – CHARACTERISTICS**
**PRESTAZIONI - PERFORMANCES**

CTH 330	rpm	Vuoto - Vacuum (%)				Pressione - Pressure (bar abs)															
		55		60 *		1,0		1,2		1,4		1,6		1,8		2,0		2,1		2,2 *	
		Q	P	Q	P	Q	P	Q	P	Q	P	Q	P	Q	P	Q	P	Q	P	Q	P
		m <sup>3</sup> /h (cfm)	kW	m <sup>3</sup> /h (cfm)	kW	m <sup>3</sup> /h (cfm)	kW	m <sup>3</sup> /h (cfm)	kW	m <sup>3</sup> /h (cfm)	kW	m <sup>3</sup> /h (cfm)	kW	m <sup>3</sup> /h (cfm)	kW	m <sup>3</sup> /h (cfm)	kW	m <sup>3</sup> /h (cfm)	kW	m <sup>3</sup> /h (cfm)	kW
3300	2199 (1294)	58	2092 (1231)	62,5	3060 (1801)	11,5	2662 (1567)	30	2587 (1523)	48,5	2513 (1479)	67	2438 (1435)	85,5	2363 (1391)	104	2326 (1369)	113	2289 (1347)	122,5	
2900	1866 (1098)	50	1763 (1038)	54	2668 (1570)	8	2325 (1368)	24	2232 (1314)	40	2139 (1259)	56	2047 (1205)	72	1954 (1150)	88	1913 (1126)	96	1868 (1099)	104	
2500	1533 (902)	42,5	1434 (844)	46	2267 (1334)	6	1938 (1141)	19	1837 (1081)	33	1736 (1022)	47	1635 (962)	61	1534 (903)	74,5	1484 (873)	81	1434 (844)	88	
2100	1200 (706)	35	1104 (650)	38	1848 (1088)	4	1550 (912)	15	1441 (848)	27	1331 (783)	38,5	1222 (719)	50	1112 (654)	62	1058 (623)	67	1300 (765)	73	
1700	867 (510)	28	675 (397)	30,5	1419 (835)	2,5	1163 (685)	12	1060 (624)	21	958 (564)	30,5	855 (503)	40	752 (443)	49	700 (412)	54	649 (382)	59	

**CONDIZIONI DI RIFERIMENTO - REFERENCE CONDITIONS**

Gas convogliato: aria - Conveyed gas: air

Temperatura di riferimento - Ambient reference temperature: 20°C (68°F)

Pressione assoluta di riferimento - Absolute reference pressure: 1013mbar (14.7psi)

Funzionamento in vuoto: scarico atmosferico - Vacuum condition: atmospheric discharge

Funzionamento in pressione: aspirazione atmosferica - Pressure condition: atmospheric suction

\* Condizioni escluse dal servizio continuo. - \* conditions not foreseen for continuous duty.

I dati riportati in tabella si riferiscono al decompressore privo del gruppo di aspirazione, e sono soggetti ad una tolleranza pari a +/- 5%. - Actual performance may vary of 5% and are referred to the vacuum pump without suction group.

**PESO E PRESSIONE SONORA – WEIGHT AND SOUND PRESSURE**

Peso CTH 330 con trasmissione diretta – CTH 330 weight with direct transmission

300 kg (660 lb)

Pressione sonora della sola pompa, rpm max a 7m in campo libero – Sound pressure of the pump only, max rpm at 7m in free field

77 dB(A)

**DIMENSIONE – DIMENSIONS [mm]**
